

## Technical Specifications

<b>Power Supply</b>	21.6...25.2VDC PELV
<b>Power Consumption</b>	Standby: <100 mW Red: 1.5W Green: 4.8W Blue: 1W Warm White: 12W
<b>Rated Luminous Flux Warm White</b>	typ. 975lm
<b>Color Temperature Warm White</b>	typ. 3000K
<b>Dimming</b>	1...100%
<b>Beam Angle</b>	Warm White: 30° RGB: diffused 120°
<b>CRI</b>	min. 80, typ. 83
<b>PWM Signal</b>	400Hz
<b>Rating</b>	Safety Rating IP20
<b>Ambient Temperature</b>	-40...55°C / -40...131°F
<b>Humidity</b>	95% r.H. (non condensing)
<b>Max. drop from ceiling to lower edge of pendant</b>	2 meters
<b>Connection</b>	with Clamps
<b>Maintenance &amp; Cleaning</b>	This device is free of maintenance and may only be cleaned with a dry cloth.

# LOXONE

## Need Help?

[loxone.com/support](https://loxone.com/support)

Loxone Electronics GmbH  
Smart Home 1  
4154 Kollerschlag  
Austria

[loxone.com](https://loxone.com)



VZ21119

# LOXONE



## LED Pendulum Slim RGBW Tree

Part No: 100308 (White)  
Part No: 100309 (Anthracite)

## About the product

The LED Pendulum Slim RGBW Tree is a tubular pendant Luminaire providing coloured or warm white light using the latest RGBW LED technology. It is best controlled with the Loxone Tree Extension.

## Installation & electrical connection

The installation of this device has to be carried out by a qualified person. The device has to be fitted in accordance with building regulations for electrical and fire safety. If the device is not installed according to manufacturers guidelines the protection of the device may be affected.

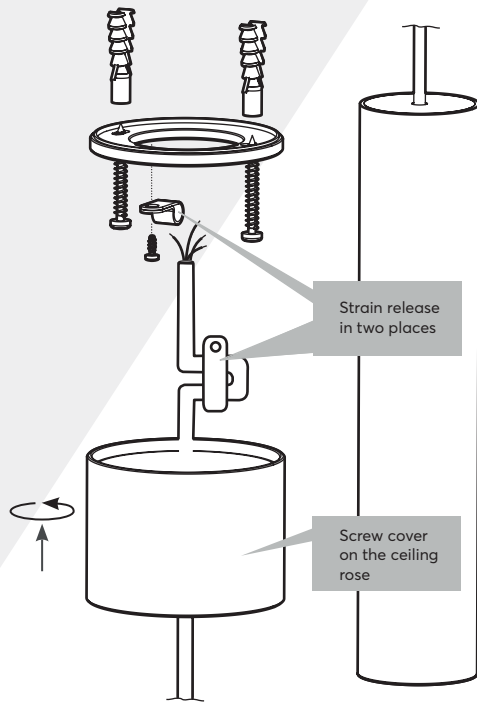

This folder is a part of the product!



For additional information, declaration of conformity, visit [www.loxone.com/help/led\\_pendulum\\_slim\\_tree](http://www.loxone.com/help/led_pendulum_slim_tree)

